

## 90 mollys Grass

### Table of Contents

- | [Property Details](#)
- | [Photo Gallery](#)
- | [Map](#)
- | [Contact For Inspection](#)

## Property Details

### 90 Mollys Grass Road, TREGEGGLE



**SOLD BY THE WAL MURRAY RURAL DEPARTMENT**

4  2  8 

Bring the kids, bring the bikes and bring the toys - this 4 bedroom home with inground swimming pool has magnificent views all the way through to Woodburn. Inside there are 4 generous bedrooms, main bedroom with ensuite, all have carpet flooring, ceiling fans, and built-in cupboards. The current owners have just finished putting new ceiling fans throughout, led lighting and powerpoints with USB connections. Other than the bedrooms, the entire house is tiled throughout.

A large open living area has plenty of room for larger furniture along with a perfect set up to wall mount your television. The separate dining area has access to the rear covered entertaining area giving you ample room to entertain your guests or enjoy outdoor living in the summer

- 4 Bedrooms
- 2 Bathrooms
- 2 Toilets
- 4 Garages
- 4 Carports
- In Ground Pool
- Deck
- Outdoor Entertaining
- Shed
- Built In Robes
- Dishwasher

months. An updated kitchen with plenty of bench space and storage along with an electric cooktop, oven, and dishwasher. The main bathroom also has a bathtub, shower cubicle and separate toilet.

Spend the summer months outside in the inground saltwater pool.

Storage is no issue, a 6m x 9m shed with power and double carport attached is perfect for the motoring enthusiast or someone who has other hobbies or interests .

Got an extended family? There is an existing Frame Steel (company name located in Brisbane) granny flat with council approval potential. Water & electricity are connected and it has an open living space with 2 utility rooms, kitchen bench space, internal laundry and shower. A large front timber deck with great views and established gardens surround the property.

Water is sourced via a crystal clear bore which is pumped up to a large cement inground tank which also collects all rainwater. There's a creek passing through the front of the property which is perfect if you wish to run livestock.

With its convenient location, including major schools, shopping, and medical facilities, it also is within a 30 minute drive to Ballina and surrounding beaches.

For your private inspection please call Gary Ghilardi on 0438 868 627

---

**\$1,300,000**

## Photo Gallery





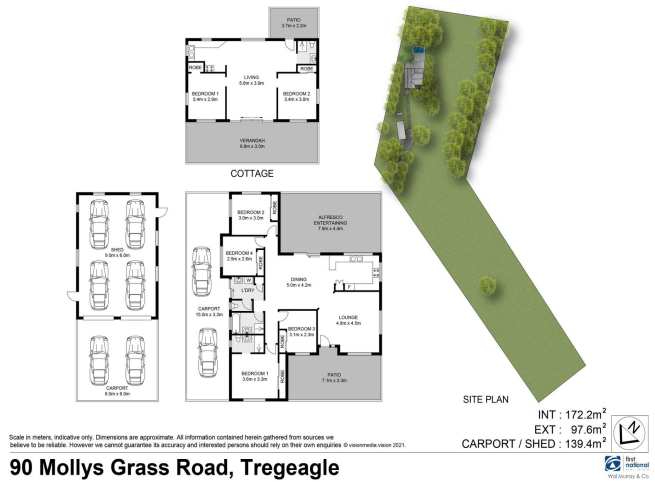

## Map



## Contact For Inspection



**GARY GHILARDI**

RURAL & LIFESTYLE SALES SPECIALIST

---

0438 868 627

[garyg@walmurray.com.au](mailto:garyg@walmurray.com.au)